

ROD COUPLING NUT

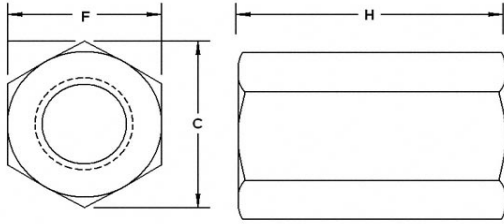

HEX ROD COUPLING NUT

COMMON SIZES LISTED. OTHER SIZES, THICKNESSES AND LENGTHS AVAILABLE UPON REQUEST

SIZE	"F" MAX	"F" MIN	"C" MAX	"C" MIN	"H"
1/4"-20	.375"	.365"	.433"	.416"	.875"
5/16"-18	.50"	.489"	.577"	.557"	.875"
3/8"-16	.50"	.489"	.577"	.557"	1.125"
1/2"-13	.625"	.613"	.722"	.698"	1.25"
5/8"-11	.813"	.782"	.939"	.891"	2.125"

SIZE	ZINC	HDG	18-8SS	316SS	QTY
1/4"-20	RC14	HDGRC14	SSRC14	316SSRC14	100
5/16"-18	RC516	HDGRC516	SSRC516	316SSRC516	100
3/8"-16	RC38	HDGRC38	SSRC38	316SSRC38	100
1/2"-13	RC12	HDGRC12	SSRC12	316SSRC12	50
5/8"-11	RC58	HDGRC58	SSRC58	316SSRC58	25

REDUCING ROD COUPLING NUT ZINC PLATED

3/8"-16 THREAD TO 1/4"-20 THREAD	REDRC3814
1/2"-13 THREAD TO 3/8"-16 THREAD	REDRC1238

STANLEY
SALES